

Instruction Self-Test-Study

Version 1 – 30.11.20

English

Please check if the following test components are available

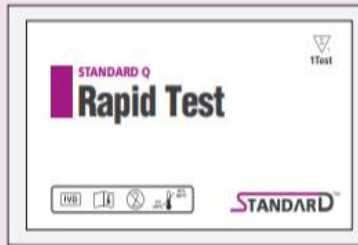

Test device
(individually in a foil
pouch with desiccant)



**Extraction buffer
tube**

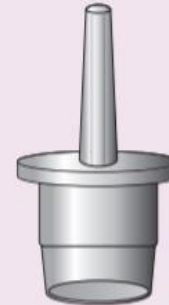

Nozzle cap



Sterile swab

Test procedure I

1. Open the extraction buffer tube and insert the swab **with the cotton part first**.
2. While **squeezing the buffer tube in the lower part**, stir the swab more **than 10 times**. (1).
3. **Remove the swab while squeezing the sides of the tube in the lower part** to extract the liquid from the swab (2).
4. Press the nozzle cap tightly onto the tube (3).

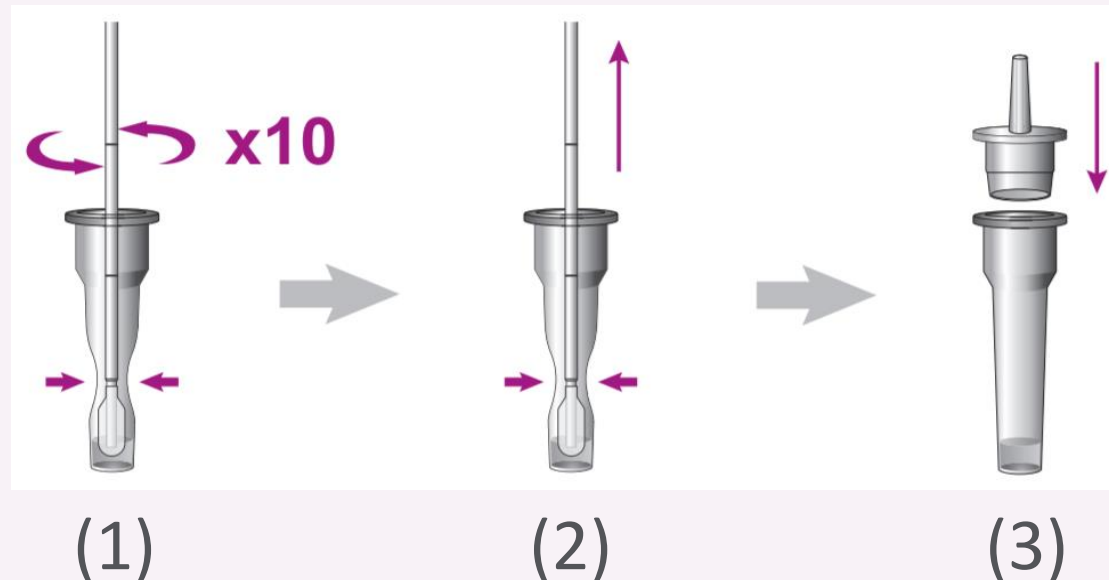

Test procedure II

5. Check the expiry date on the back of the foil pouch (1).
6. Open the foil pouch of the test card at the **tear line** (2) and put the test device on the table.
7. Ensure that the **desiccant** status indicator shows valid (yellow) (4).

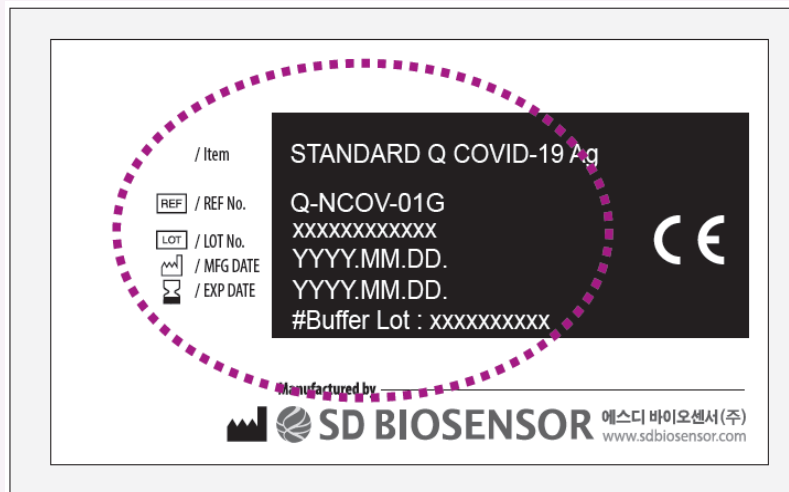

(1)

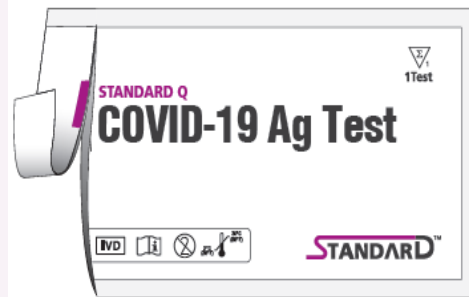

(2)



(3)



(4)

Test procedure III

8. Place the test **horizontally** in front of you as shown in figure (1).
9. Hold the tube **vertically over the marked round field** (not the rectangle result window) (1).
10. Squeeze the tube for applying **4 drops** of extracted specimen to the specimen well of the test device (1). (You can also continue the test if you have accidentally applied 5 drops)
11. Set the timer and read test result at 15 min (2).

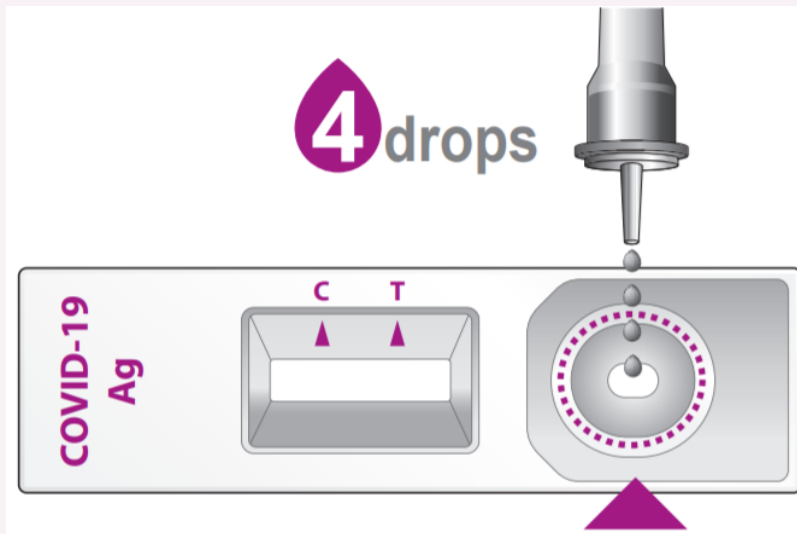

(1)



(2)

Interpretation

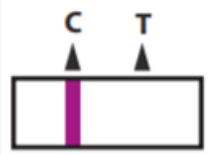
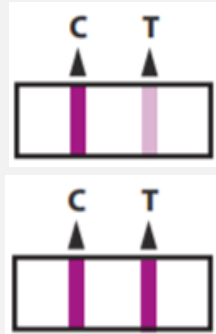
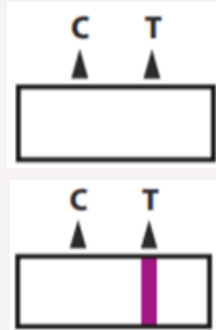
Test Result	Example	Description
Negative		Negative: A colored band will appear in the left section of the result window to show that the test is working properly. This band is control line (C). -> no sign of infection
Positive		Positive: A colored band will appear in the right section of the result window. This band is test line of SARS-CoV-2 antigen (T). -> sign of infection
Invalid		Invalid: If no control line (C) is visible, the result is considered invalid. -> the test is not working properly

-> Also pay attention to faint lines <-

Weak (pale) or irregular lines should also be considered.